

8

7

6

5

4

3

2

1

ALL SPECIFICATIONS APPLY AT 1013 MILLIBAR, 25°C, DRY AMBIENT AIR.

REV.	DCO'S AFFECTING THIS DRAWING	DATE	APPROVED
A	INITIAL REL.# 2171	10/12/05	D.L.
D	DCO # 5157 UPDATED SPECIFICATIONS	10/23/14	D.LARSEN

1. Output:

25mV to 35mV

2. Operating Temperature:

10° C to 40° C

3. Maximum Storage Temperature:

-20° C to 50° C

(Recommended: 5° C to 30° C)

4. Electrical Connection:

Two gold plated slip rings

5. Range of Measurement (Full Scale):

0 to 100% oxygen

6. Zero Offset:

Less than or equal to 0.20 mV when exposed to 100% nitrogen for 5 minutes.

7. 90% Response Time:

Less than or equal to 17 seconds

8. Linearity:

≤ 3% AT 100% O₂, applied for 5 minutes

9. Interference: PER DIN EN ISO 21647 and ISO 7767

- Less than 0.3% of full scale in presence of 80% Nitrous oxide
- Less than 0.3% of full scale in presence of 7.5% Halothane
- Less than 0.3% of full scale in presence of 7.5% Isoflurane
- Less than 0.3% of full scale in presence of 7.5% Enflurane
- Less than 0.3% of full scale in presence of 7.5% Sevoflurane
- Less than 0.3% of full scale in presence of 20% Desflurane
- Less than 0.3% of full scale in presence of 10% Carbon Dioxide

10. Temperature Compensation:

NTC

11. Expected Life:

>500,000% oxygen hours under normal operating conditions

12. Humidity:

Up to 100% RH

AUTHORIZED COPY
~~OCT 23 2014~~
EFFECTIVE DATE
VALID ONLY IF THIS STAMP IS RED

UNLESS OTHERWISE SPECIFIED
DIMENSIONS ARE IN INCHES
AND PER ANSI Y14.5-1982

.XX = ±.01	ANGLES
.XXX = ±.005	±1'30"
.XXXX = ±.002	

maxtec®
SALT LAKE CITY, UTAH

SPECIFICATION,
MAX-43 OXYGEN SENSOR

Q.A. G. ROTH	10/16/14	PREP Kevin Durst	11/05/04	SIZE	FSCM NO.	NUMBER	REV
MFG E. MEADS	10/1/143	CHKR Kevin Durst	10/13/05	B	1S815	R109P08	D
		ENG M. SWANK	10/8/14	SCALE: 1:1		SHEET 1 OF 2	

PROPRIETARY INFORMATION
MAXTEC

8

7

6

5

4

3

2

1

R109P08
D

4

3

2

1

D

D

C

C

B

B

A

A

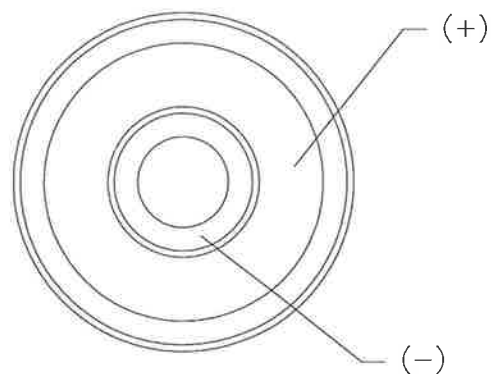
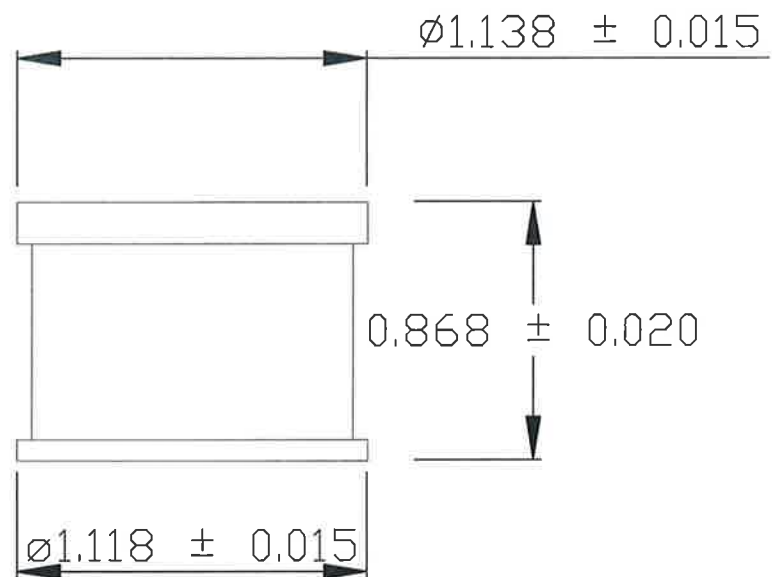

AUTHORIZED COPY
OCT 23 2014
EFFECTIVE DATE
VALID ONLY IF THIS STAMP IS RED

SIZE B	FSCM NO. 1S815	NUMBER R109P08	REV D
SCALE NONE		SHEET 2 OF 2	

PROPRIETARY INFORMATION
 MAXTEC

R109P08 D

4

3

1